



## Pump Driver (EPD) Module

### 40 AMP MAXIMUM

The Pump Driver Module (EPD) replaces the servo valve. System flow is controlled by regulating the pump speed.

### MODULE INSTALLATION

**NOTE:** The mounting surface must be cleaned so it is free from dirt, moisture and oil residues. Failure to clean the mounting surface may result in the EPD working loose.

Remove the GREEN backing from the Dual-Lock™ fasteners on the bottom of the EPD unit. Position the EPD where wiring will work the best. Extension cables are available. Firmly press the EPD into place. Secure the EPD to the equipment using plastic cable ties to prevent the EPD from coming into contact with moving parts if the Dual-Lock™ fasteners should work loose. If desired, the EPD can be fastened with screws, using the holes in the mounting flanges.

### ELECTRICAL INSTALLATION

This section explains how to hook-up your EPD to a 12-volt power connection, and how to connect your EPD to your controller harness.

The EPD **MUST** be connected to a 12-volt DC negative ground electrical system.

### POWER BATTERY CONNECTION

Locate the power cable, P/N 17871 and route to the battery. In routing cable avoid areas where the cable may be subjected to abrasion or excessive heat. Attach the BLACK wire (ground) to a screw or bolt on the equipment frame. See illustration to the upper right. Be sure there is a good metal-to-metal contact. Connect the ORANGE wire to the positive battery terminal.

Connect the power to the EPD by plugging the 2-pin M/P tower on the power cable into the 2-pin M/P shroud of the EPD module.

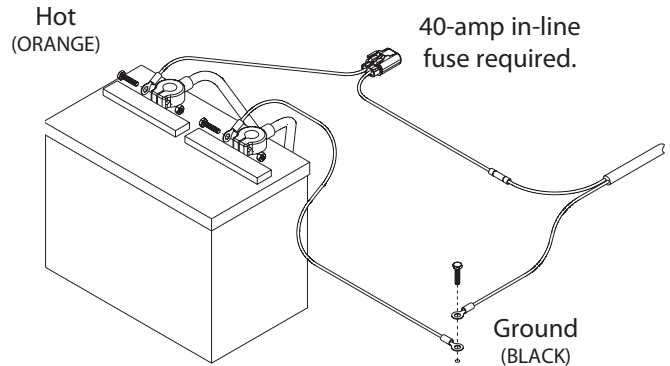

### SIGNAL AND MOTOR CONNECTIONS

Locate the boom wire, P/N 14500. Plug the 2-pin W/P shroud into the mating connector on the EPD module and plug the quick-disconnect into the mating connector on the BROWN wire (if connecting to a SprayMate system) or the YELLOW wire (if connecting to an MT-3405F or an MT-9000 system) on the controller harness as shown.

**NOTE:** Be sure to route cables away from sharp edges, areas of high heat and moving parts. Secure all cables firmly with plastic cable ties.

Locate the servo cable P/N 10450. Connect the 3-pin W/P shroud to the 3-pin W/P tower on the EPD module. Connect the other end of the cable to the mating connector on the controller harness as shown.

Locate the pump cable P/N 17872. Plug the 2-pin M/P shroud into the 2-pin M/P tower on the EPD module. Insure that the pump is running in the correct direction. If not, simply reverse the wires from the pump to the pump cable.

**See next page for applicable diagram.**



**Module Diagram**

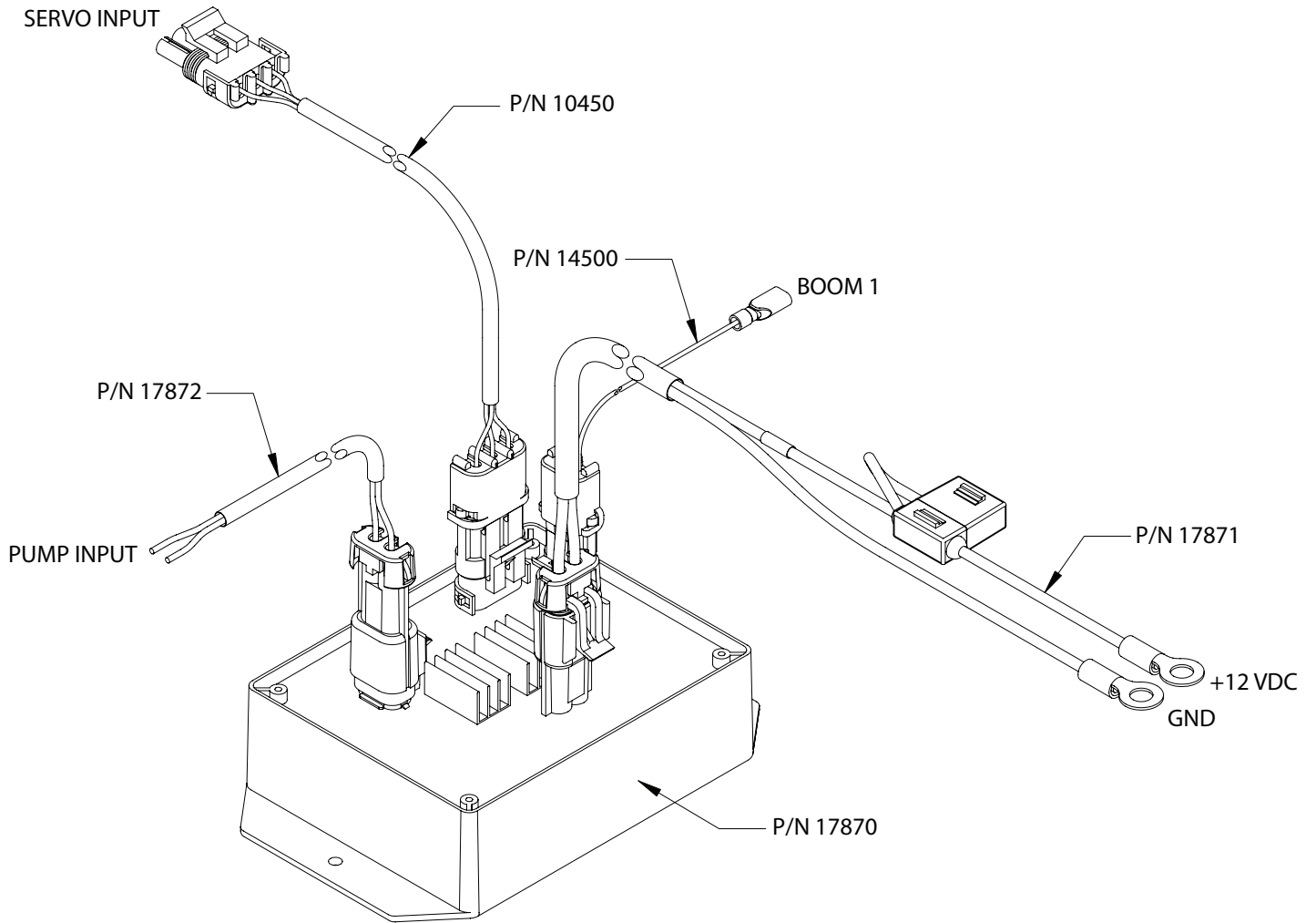

**WARNING:** Do NOT connect the motor leads to the battery or power supply. Non-warranty damage will result if the motor leads are connected to the battery or power supply.